



# Northwest Sun Tran Bus Storage and Maintenance Facility (BSMF)



Project Overview- October 2009

# Why Build Another Facility?

- The existing Sun Tran bus storage facility was built in 1977 at City's Price Service Center, at Park and Ajo Way.
- It is over capacity. Designed for 150 buses, but currently serves more than 200.
- No room for expansion.

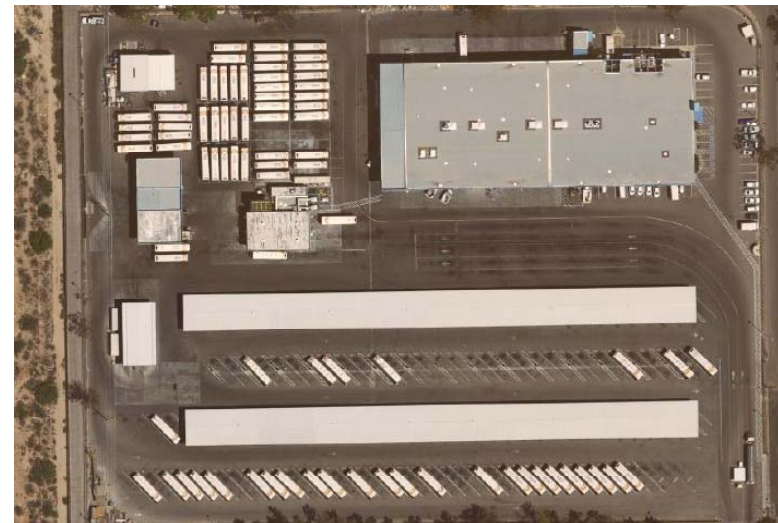

# Future Facility Needs

- In 2006, the Regional Transportation Authority (RTA) plan was approved by voters. \$534 million for transit.
- more weekend and evening service
- more frequent service
- extended local and express routes
- more new buses

**= need for more bus storage**

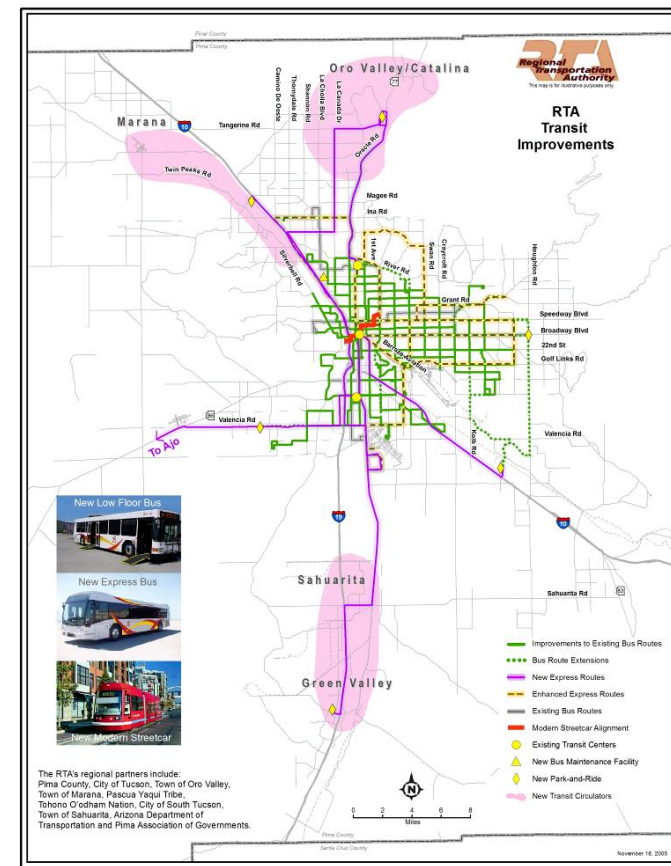



# Northwest Facility History

A decorative graphic element consisting of a horizontal bar with a gradient from dark purple on the left to bright yellow on the right, ending in a rounded, arrow-like shape pointing to the right.

- In 1994, City voters approved \$4 million in General Obligation bonds for a new bus storage facility.
- In 1995, the City initiated a Facility Needs Assessment and Alternative Site Analysis.
- The 25-acre site near Prince and I-10 was identified as the best option.
- In 1997, land was purchased.

# Northwest Location

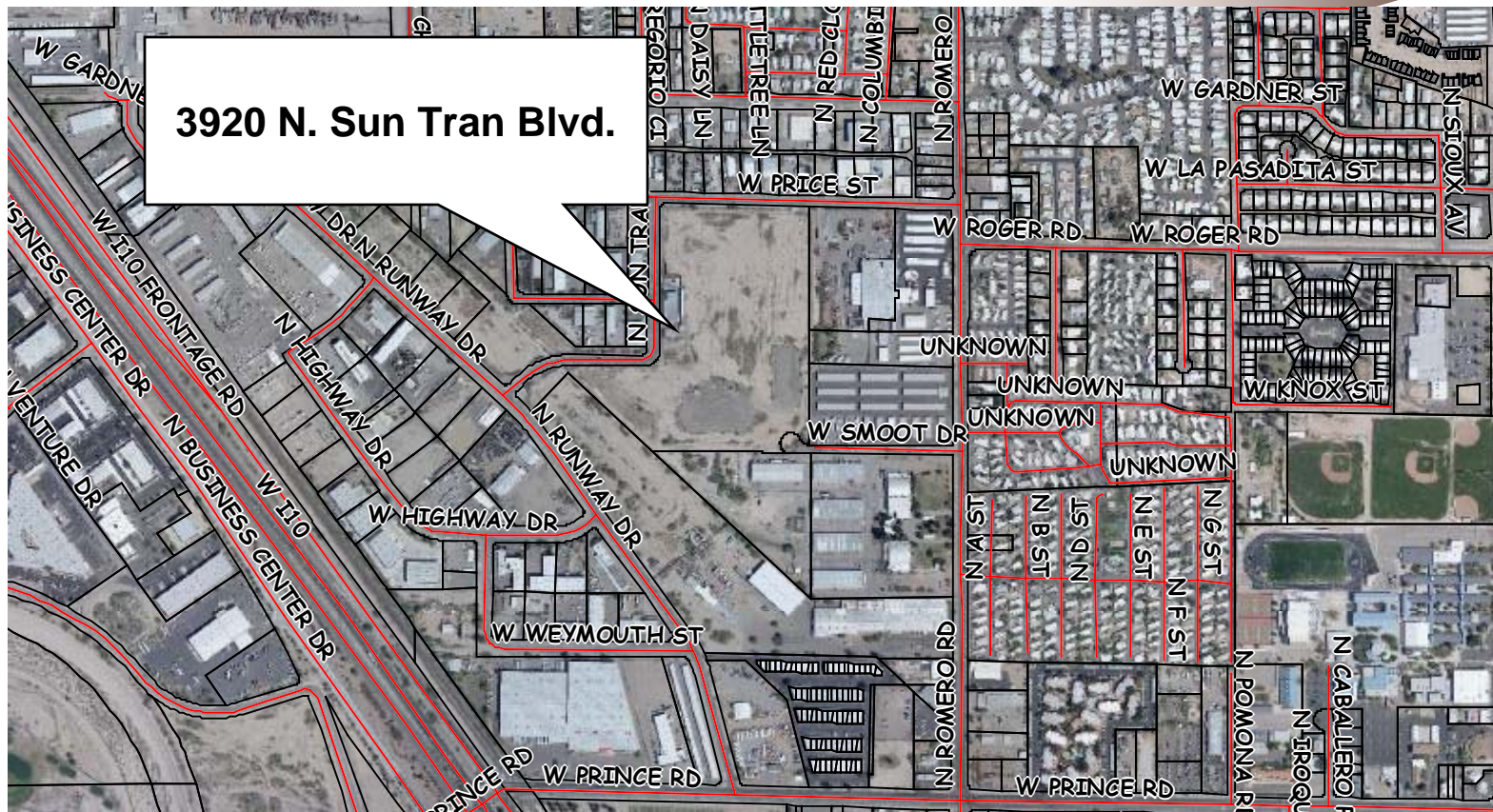

# Phase I Improvements



- In 1999, the Site Development Master Plan was completed. Three-phase construction recommended.
- In 2004, Sun Tran Blvd and fueling facility for City vehicles were constructed.



# Phase II 150-Bus Facility



- Operations building
- Maintenance building
- Fare retrieval station
- 150 bus parking spaces
- Fueling station
- Bus wash
- Temporary bus parking
- Prince/Runway traffic signal

**Complete in November**

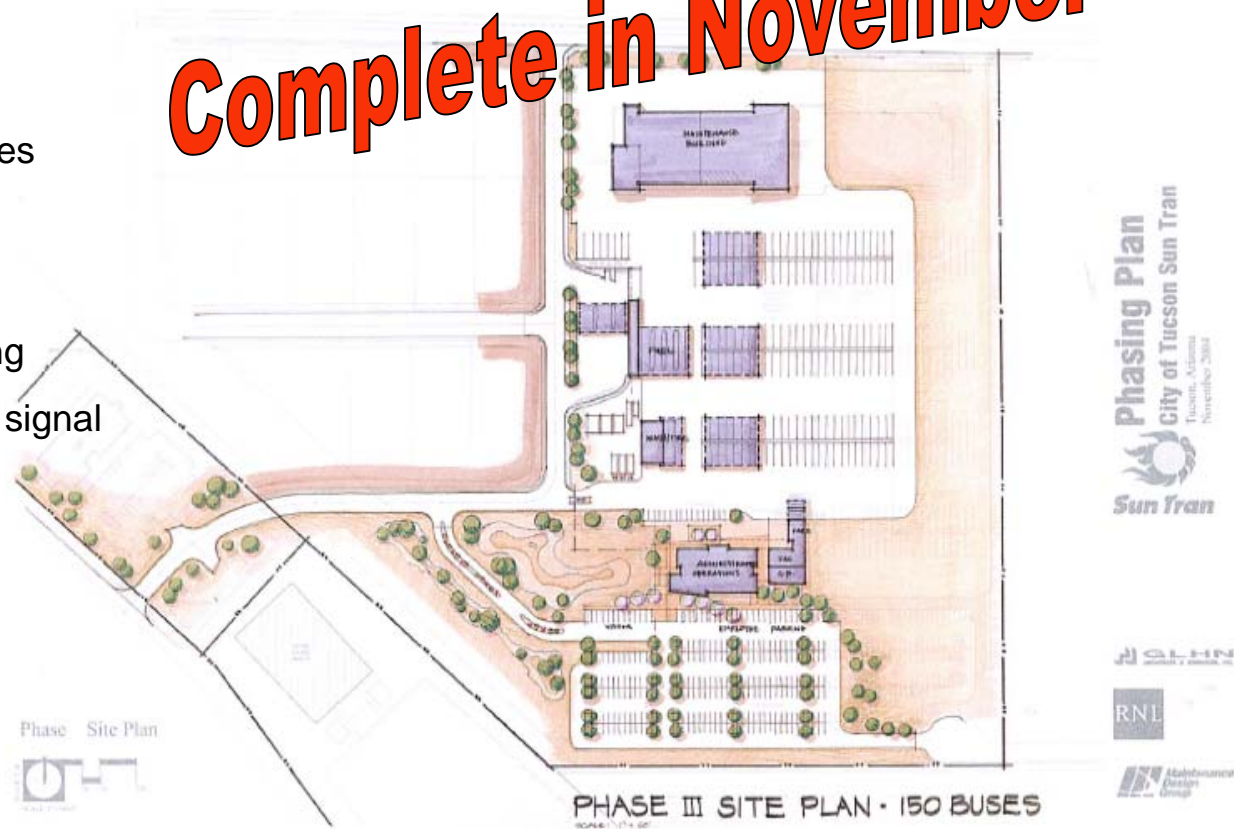

# Phase II Maintenance Building



- 50,000 square feet, 2 levels
- 17 bus bays
- 2nd floor offices
- 2-level parts storage
- employee shower & locker rooms



# Phase II Maintenance Building



- clerestory window lighting
- state-of-the-art equipment



# Phase II Operations Building



- 12,000 square feet
- offices and training room
- driver dispatch center



# Phase II Bus Canopies



- 6 metal canopies with 68kw of solar power



# Phase II Fuel Building and Tire Shop

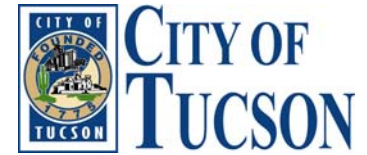

- new buses run on B-20 ultra-low sulpher bio-diesel



# Phase III 250-Bus Facility



- Expanded maintenance building
- 100 more bus parking spaces
- additional fuel storage
- additional bus wash
- New administration building

**FTA Stimulus Project for 2010**



# Phase III

# Future Administration Building



# Full Build-Out

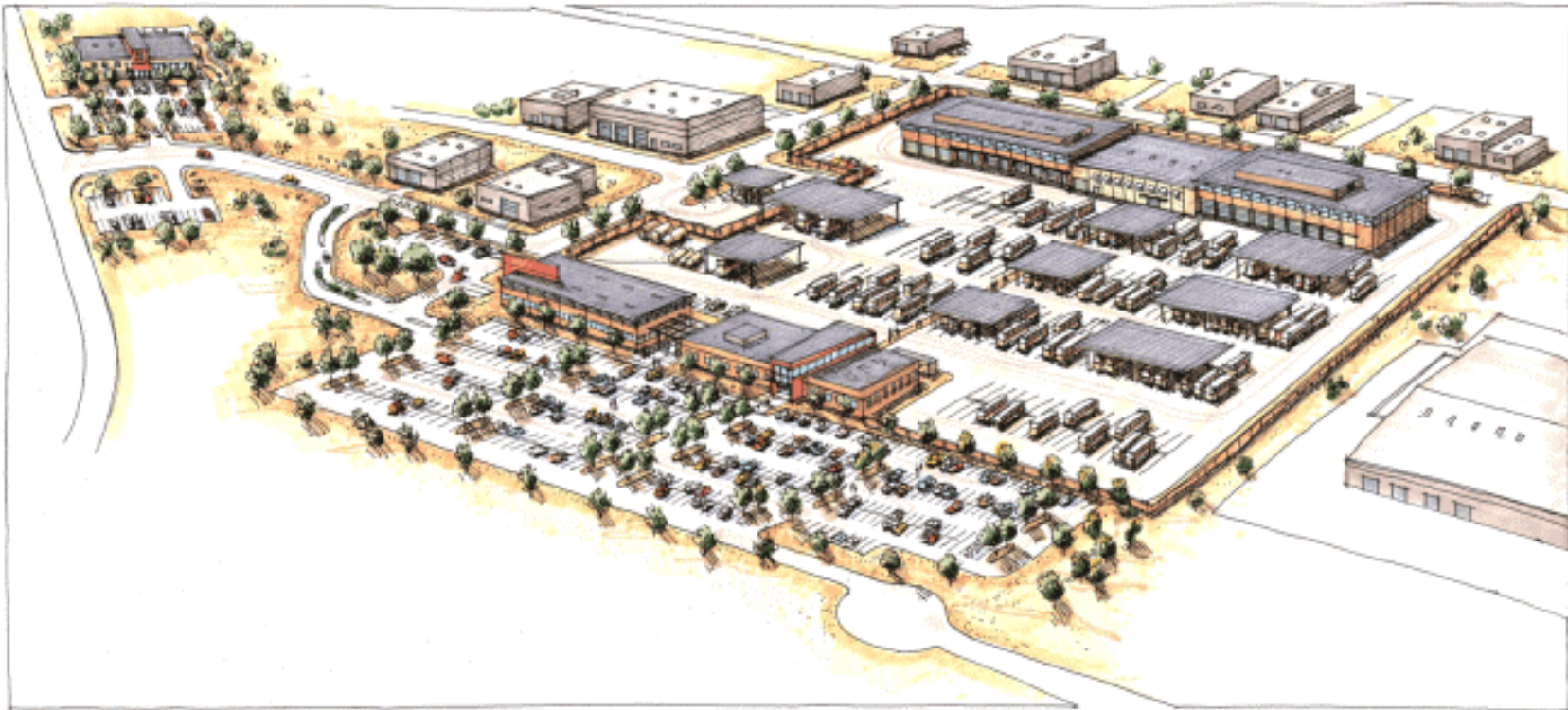

# Striving for LEED Gold Certification

**This will be a US Green Builders Council LEED Gold project.**

- 68kw Solar power generation
- reclaimed water for irrigation and stormwater harvesting
- construction waste recycling
- waterless urinals and sensor faucets
- natural lighting and Cool Communities roofing recommendations
- Bio-diesel fueled vehicles and bicycle parking
- furnishings and flooring with low VOC compounds
- building materials with post-industrial recycled content
- and much more...



# Project Funding

A large, horizontal, arrow-shaped graphic pointing to the right. It has a gradient from dark purple on the left to bright yellow on the right, with a white outline.

## **Phase I: \$8 million**

- \$4 million in 1994 City of Tucson bonds and \$4 million in FTA funds.

## **Phase II: \$32 million**

- \$22 million in RTA funds and \$10 million in FTA funds.

## **Phase III: \$16 million**

- \$16 million in FTA Stimulus funds





# Phase II Project Team



- City of Tucson: owner, project oversight
- Sun Tran: user/occupant, project technical support
- GLHN Architects: design
- D.L. Withers: general contractor
- RTA: finance
- FTA: finance

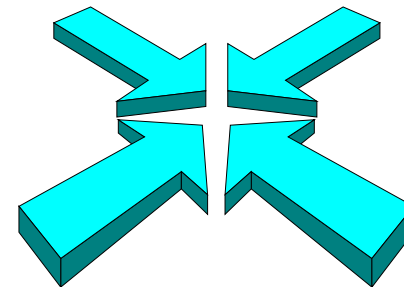

# Daily Operations

A decorative graphic consisting of a thick horizontal bar with a color gradient from dark purple on the left to bright yellow on the right, ending in a rounded, arrow-like tip pointing to the right.

- The facility will be a light-duty maintenance facility: routine maintenance and repairs, cleaning, fueling
- On-site 24-hour security, lighting, and cameras
- Operations will include approximately 100 buses to start and will add more over time
- All buses will exit via Sun Tran Blvd
- Smoot Drive access for employees only



# For more information...

A large, stylized arrow graphic pointing to the right. The arrow has a gradient from dark purple on the left to bright yellow on the right, with a white outline and a shadow effect.

## **City of Tucson Department of Transportation- Transit Division**

Tom Fisher, Project Manager. (520) 837-6752

## **City of Tucson Architecture & Engineering Division**

Bruce Woodruff, Project Manager. (520) 791-5111 x318

## **Sun Tran**

Kevin Faulkner, Director of Project Management. (520) 623-4301